



More information  
on the product



# AMTRD-ESS

Modular loadhouses

- Robust steel structure
- Bolted structure
- Quick and safe loading
- Additional protection
- Reduction of heat loss in the storage room
- Energy saving
- Weather-protected good-handling area
- Possibility of opening the trailer's door after docking



AC 082



## General information

The AMTRD-ESS loadhouses are an economical and ergonomic alternative to conventional loading bays inside a warehouse. The structure is assembled by bolting together ready-made components, without the need for welding. This universal solution can be used for all types of platforms and door seals. It is possible to adapt the loadhouse to different types of thermal insulation of the bay, to line up several loadhouses with common structural elements. The loadhouses are designed to equip new developments as well as to modernise existing facilities. The loadhouses allow dock levellers to be used if it is not possible to install them in a hall. The AMTRD-ESS loadhouse consists of a load-bearing frame set on adjustable feet and a superstructure. It features two immovable side platforms covered with corrugated 6/8 sheet metal. The integrated additional brackets make it easy to mount any platform of your choice.

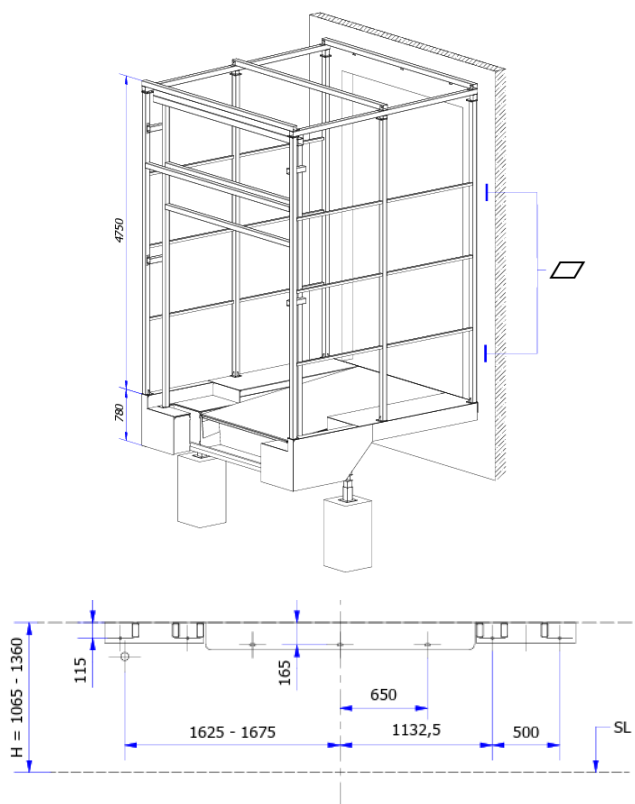

## Technical data:

<b>Application</b>	Loading systems
<b>Nominal length</b>	3000 mm
<b>Nominal width</b>	3500 mm
<b>Structural height (bottom structure + upper structure)</b>	1065 - 1360 mm (down) + 4750 (up)
<b>Load bearing capacity</b>	6 tons (60 kN)
<b>Step dock height</b>	200 mm
<b>Step dock length</b>	1250 mm
<b>Water discharge</b>	trough the front edge
<b>Maximum wind resistance</b>	(Eurocode 3) 0,84 kN/m <sup>2</sup>
<b>Maximum resistance to snow pressure</b>	(Eurocode 3) 2,00 kN/m <sup>2</sup>
<b>Sheet thickness</b>	6/8 mm
<b>Standard colors</b>	■ RAL 9005

\* Possibility to adapt the product to customer requirements.

## Additional options

- the whole structure or its individual components can be painted in a different RAL colour than the standard one or hot-dip galvanised,
- the design of the loadhouse is adapted to accommodate a pneumatic seal,
- powder coating.